



figure

229

ends
formflanged
straight **BELLOW SEALED STOP VALVE**

| body material | nominal pressure | nominal diameter | max temperature |
|------------------------|----------------------------|------------------|-----------------|
| A grey cast iron | C 16 bar | DN 15-250 | 300°C |
| C nodular cast iron | C 16 bar D 25 bar | DN 15-200 | 350°C |



correspond to the pressure equipment directive 97/23/EC
marking CE for Dn≥32

FEATURES

- high tightness (leakproofness class - A acc. EN -12266 - 1)
- compact settlement
- environment-friendly
- tests acc. EN - 12266 - 1
- flanges drilled according to EN 1092-2
- face-to-face dimension according to EN 558-1 series 1

APPLICATION

- hot and cold water plants
- steam plants
- diathermic oil plants
- industrial technologies
- power engineering

Data given can be changed without notice.

Edition 04/2009



figure

229

ends
form

flanged
straight

MATERIALS

type 01; 04

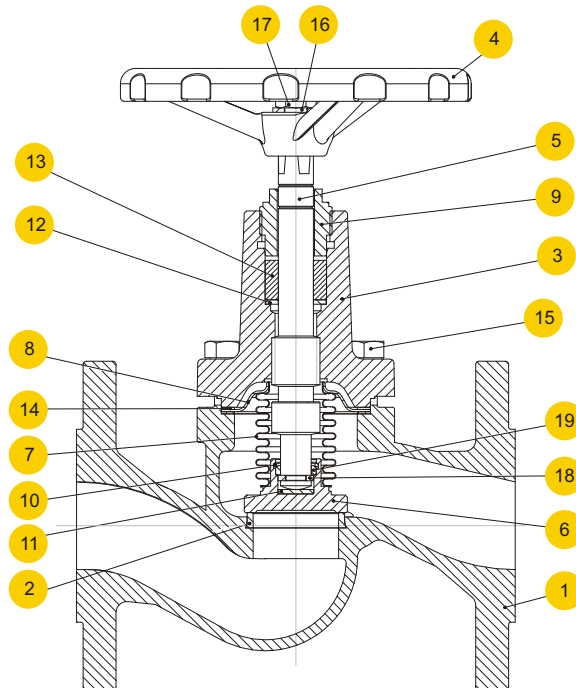

type 71

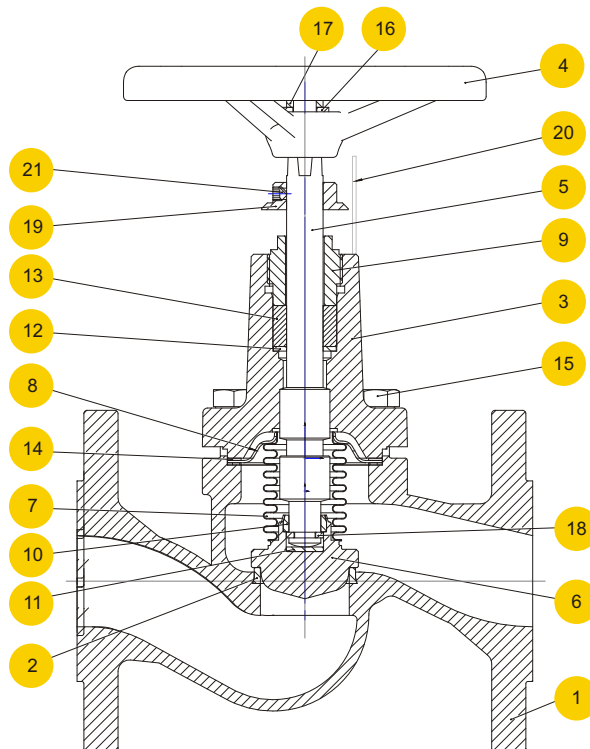

Data given can be changed without notice.

Edition 04/2009



figure

229

ends
form

flanged
straight



ZETKAMA

MATERIALS

| body material | | A | | C | |
|------------------|-------------------|-----------------------------|--------------------------------|-------------------------------|--------------------------------|
| type | | 01; 04 | 71 | 01; 04 | 71 |
| 1 | body | EN – GJL-250 JL1040 | | EN – GJS400 - 18-LT JS1025 | |
| 2 | seat ring | X12Cr13 1.4006 | | X12Cr13 1.4006 | |
| 3 | bonnet | EN – GJL-250 JL1040 | | EN – GJS400 - 18-LT JS1025 | |
| 4 | hand-wheel | EN – GJS-500-7 JS1050 | | | |
| 5 | stem | X20Cr13 1.4021 | | | |
| 6 | disc | X20Cr13 1.4021 | | | |
| 7 | bellow | X6CrNiMoTi17-12-2 1.4571 | | | |
| 8 | bellow basin | X5CrNiMoTi18-10 1.4301 | | | |
| 9 | gland | S235JR 1.0037 | | | |
| 10 | spring ring | X17CrNi16-2 1.4057 | | | |
| 11 | washer | X30Cr13 1.4028 | | | |
| 12 | washer | X20Cr13 1.4021 | | | |
| 13 | gland packing | graphite | | | |
| 14 | gasket | graphite + NiCr | | | |
| 15 | hexagon bolt | 8.8 | | A2-70 | |
| 16 | washer | carbon steel | | | |
| 17 | nut | 8 + zinc galvanized | | | |
| 18 | split ring cotter | X20Cr13 1.4021 | | | |
| 19 | ring | X20Cr13 1.4021 | | | |
| 20 | position inductor | ----- | carbon steel + zinc galvanized | ----- | carbon steel + zinc galvanized |
| 21 | tap screw | ----- | carbon steel | ----- | carbon steel |
| max. temperature | | 300°C | | 350°C | |

Data given can be changed without notice.

Edition 04/2009



figure **229**

ends form flanged straight

DIMENSIONS

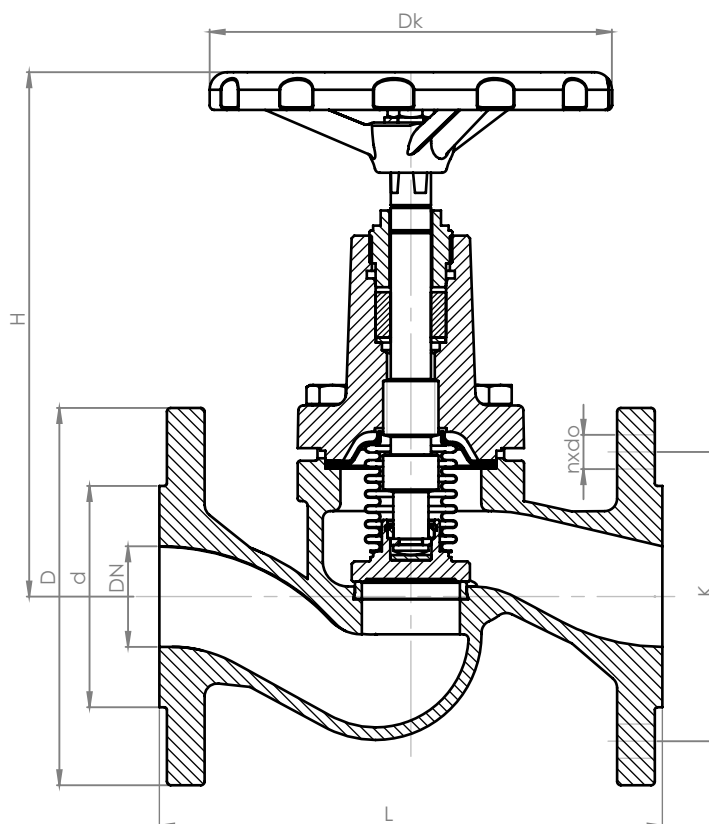

| DN | PN 16 | | | | PN 25 | | | | PN 16,25 | | | | type 71 | | | | |
|-----|-------|-----|-----|--------|-------|-----|-----|--------|----------|----|-----|-----|-------------------|-------|-----|-------------------|------|
| | D | d | K | n x do | D | d | K | n x do | Dk | h | L | H | Kvs | | H | Kvs | |
| mm | | | | | | | | | | | | | m ³ /h | kg | mm | m ³ /h | kg |
| 15 | 95 | 46 | 65 | 4x14 | 95 | 46 | 65 | 4x14 | 100 | 5 | 130 | 159 | 5,9 | 3,2 | 175 | 3,4 | 3,8 |
| 20 | 105 | 56 | 75 | 4x14 | 105 | 56 | 75 | 4x14 | 100 | 5 | 150 | 159 | 7,4 | 3,9 | 175 | 6,3 | 4,5 |
| 25 | 115 | 65 | 85 | 4x14 | 115 | 65 | 85 | 4x14 | 100 | 7 | 160 | 169 | 13,0 | 4,6 | 185 | 9,4 | 5,4 |
| 32 | 140 | 76 | 100 | 4x19 | 140 | 76 | 100 | 4x19 | 100 | 8 | 180 | 176 | 18,0 | 6,3 | 195 | 16,0 | 7,2 |
| 40 | 150 | 84 | 110 | 4x19 | 150 | 84 | 110 | 4x19 | 160 | 10 | 200 | 208 | 30,0 | 8,7 | 235 | 26,0 | 10,0 |
| 50 | 165 | 99 | 125 | 4x19 | 165 | 99 | 125 | 4x19 | 160 | 13 | 230 | 225 | 41,0 | 12,3 | 245 | 40,0 | 13,8 |
| 65 | 185 | 118 | 145 | 4x19 | 185 | 118 | 145 | 8x19 | 160 | 16 | 290 | 245 | 79,0 | 16,3 | 270 | 70,0 | 19,0 |
| 80 | 200 | 132 | 160 | 8x19 | 200 | 132 | 160 | 8x19 | 200 | 20 | 310 | 294 | 115 | 22,4 | 310 | 106 | 25,4 |
| 100 | 220 | 156 | 180 | 8x19 | 235 | 156 | 190 | 8x23 | 200 | 25 | 350 | 330 | 181 | 34,0 | 370 | 170 | 38,0 |
| 125 | 250 | 184 | 210 | 8x19 | 270 | 184 | 220 | 8x28 | 250 | 32 | 400 | 334 | 225 | 50,0 | 420 | 245 | 56,5 |
| 150 | 285 | 211 | 240 | 8x23 | 300 | 211 | 250 | 8x28 | 320 | 40 | 480 | 432 | 364 | 74,0 | 505 | 360 | 80,0 |
| 200 | 340 | 266 | 295 | 12x23 | 360 | 274 | 310 | 12x28 | 360 | 50 | 600 | 515 | 690 | 130,5 | 577 | - | 130 |
| 250 | 405 | 319 | 355 | 12x28 | - | - | - | - | 360 | 65 | 730 | 595 | 1010 | 210 | - | - | - |

Data given can be changed without notice.

Edition 04/2009



figure

229

ends
formflanged
straight

ZETKAMA

PRESSURE-TEMPERATURE RATINGS

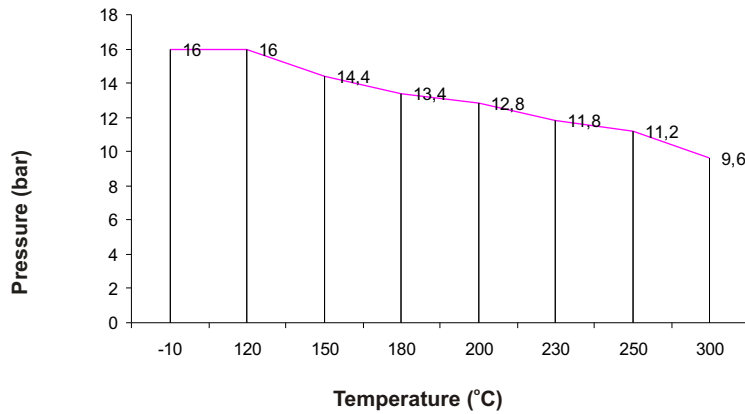

Allowed working conditions range
PN 16 EN-GJL-250

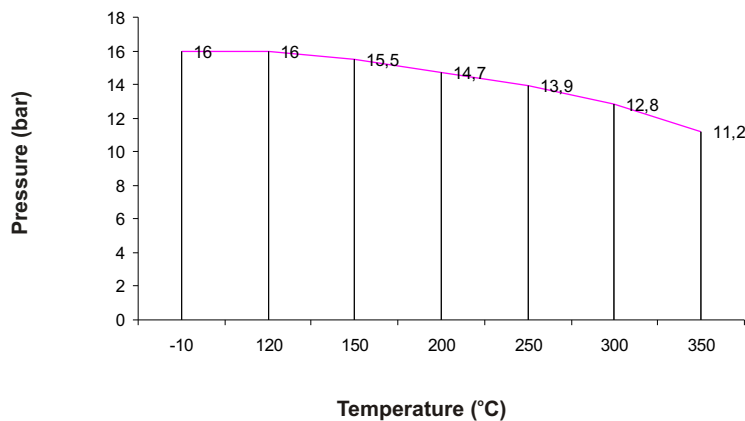

Allowed working conditions range
PN 16 EN-GJS-400-18-LT

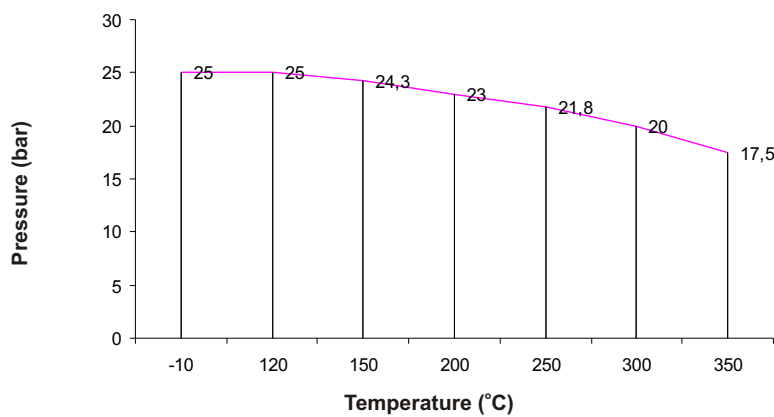

Allowed working conditions range
PN 25 EN-GJS-400-18-LT

Data given can be changed without notice.

Edition 04/2009



| | |
|-----------|------------------|
| figure | 229 |
| ends form | flanged straight |

TYPES

| figure | body material | nominal diameter DN | nominal pressure PN | type |
|--------|--|---------------------|---------------------|--|
| 229 | A grey cast iron EN-GJL-250 | 15-150 mm | C 16bar | 01 Tmax 300 °C • disc connected with bellow • stem, disc, bellow and seat ring - stainless steel |
| | | 200-250 mm | C 16bar | 04 Tmax 300 °C • balancing disc connected with bellow • stem, disc, bellow and seat ring - stainless steel |
| | | 15-200 mm | C 16bar | 71 Tmax 300 °C • throttling disc connected with bellow • stem, disc, bellow and seat ring - stainless steel |
| | C nodular cast iron EN-GJS-400-18-LT | 15-150 mm | C 16bar | J 01 Tmax 350 °C • disc connected with bellow • stem, disc, bellow and seat ring - stainless steel |
| | | 200 mm | C 16bar | 04 Tmax 350 °C • balancing disc connected with bellow • stem, disc, bellow and seat ring - stainless steel |
| | | 15-200 mm | C 16bar | 71 Tmax 350 °C • throttling disc connected with bellow • stem, disc, bellow and seat ring - stainless steel |
| | | 15-150 mm | D 25bar | J 01 Tmax 350 °C • disc connected with bellow • stem, disc, bellow and seat ring - stainless steel |
| | | 200 mm | D 25bar | 04 Tmax 350 °C • balancing disc connected with bellow • stem, disc, bellow and seat ring - stainless steel |
| | | 15-200 mm | D 25bar | 71 Tmax 350 °C • throttling disc connected with bellow • stem, disc, bellow and seat ring - stainless steel |

ORDERING

To place an order please use our product number (index)



ORDER EXAMPLE

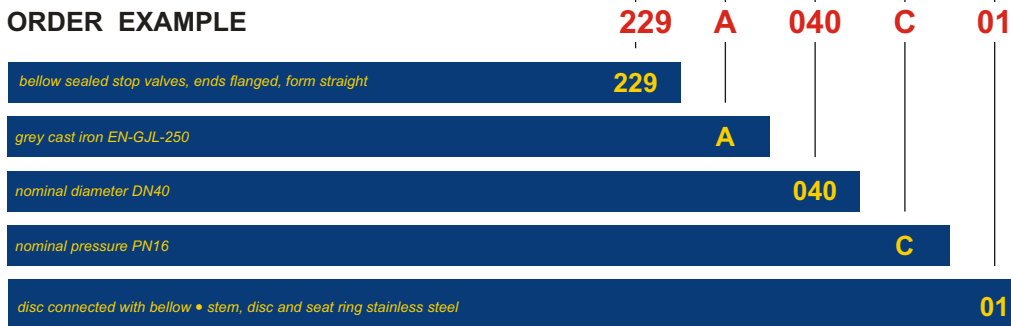

Data given can be changed without notice.

Edition 04/2009